

# 智能门禁

# K2/K2F

## 使用说明

### 智能门禁 K2/K2F

产品型号 :	K2/K2F
尺寸 :	W79mm x H125mm x T15.5mm
材质 :	铝合金框架/玻璃面板
通信方式 :	Bluetooth 4.1
支持系统 :	Android 4.3/IOS7.0 above
待机电流 :	≈5mA
动作电流 :	≈1A
供电方式 :	12V
开锁时间 :	≈1.5S
防水等级 :	IP66
卡片容量 :	20000张

### 包装配件

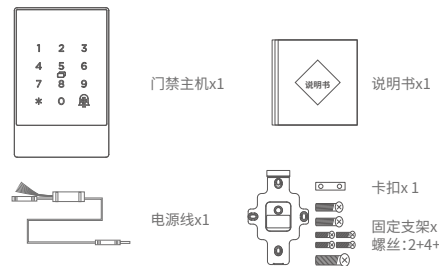

### 安装步骤

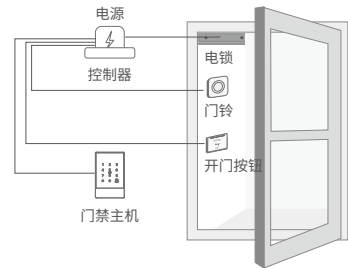

#### 1. 开孔

在合适的位置上,打通门禁线缆连接电源的线槽。

#### 2. 安装固定支架

在门禁线槽位置上,用自攻螺丝将固定支架固定。

### 3. 接线

将门禁线缆分别接通到电源及对应线束上。

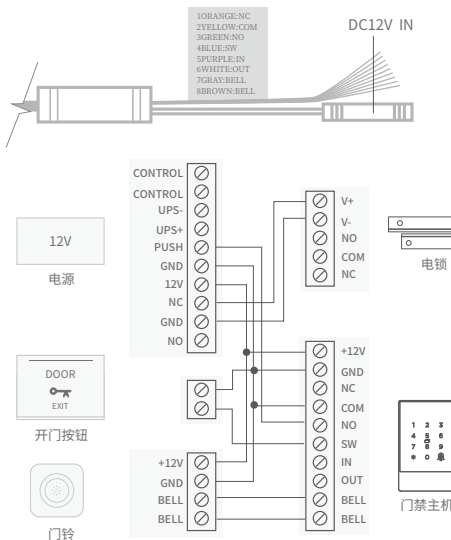

### 4. 安装卡扣

将主机背面上的卡扣用螺丝固定。

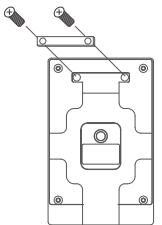

### 5. 安装主机

将主机装入到固定支架后,用螺丝固定。

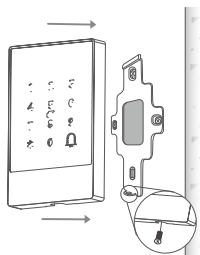

### 添加门禁(绑定管理员)

1. 点按触摸屏任意数字激活门锁
2. 在听到“请添加蓝牙管理员”语音提示后,打开 app 软件

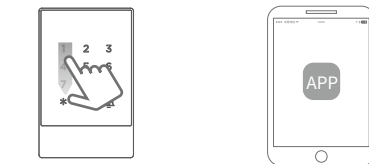

3. 点击左上角“≡”进入“添加锁”,选择门锁(门禁)类型
4. 点击发现的锁设备名称,等待几秒钟,直至锁发出一声长“嘀”或语音提示“添加成功”

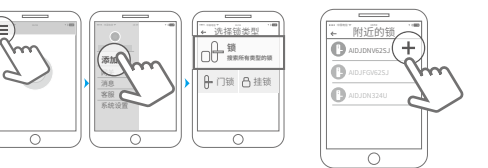

● 注意:如果通过以上步骤未能成功添加锁,请关闭手机APP,关闭手机蓝牙后再重新打开APP与蓝牙,重复以上步骤。

### 产品保修说明

- 1、自购买产品之日起7日内,若产品出现非人为损坏的质量问题,可以选择按购买价格退货或更换同型号产品;
- 2、自购买产品之日起至第十五日内,若产品出现非人为损坏的质量问题,可以选择免费更换同型号的产品;
- 3、自购买产品之日起12个月内,若产品出现非人为损坏的性能故障,提供免费维修服务。

# SMART ACCESS CONTROLLER

# K2/K2F

Manual

## Smart Access Controller K2/K2F

Model :	K2/K2F
Dimensions :	W79mm x H125mm x T15.5mm
Material :	Aluminum frame/Tempered glass panel
Communication :	Bluetooth 4.1
Supporting systems :	Android 4.3/iOS7.0 above
Stand-by current :	≈5mA
Operating current :	≈1A
Power supply :	12V
Unlocking time :	≈1.5S
Waterproof level :	IP66
Card capacity :	20,000 Cards

## Accessories

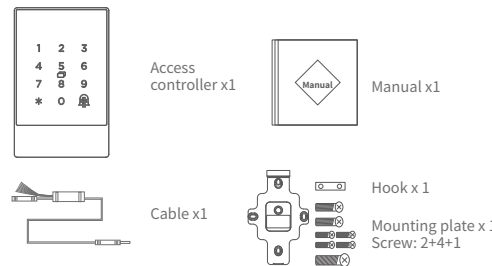

## Illustration

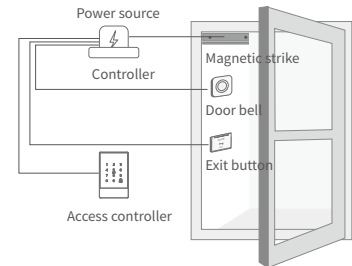

- 1 Drill a hole for the cable
- 2 Install the mounting plate

Drill a hole at appropriate position to make space for the cable to connect to the power source.

Fix the mounting plate with 4 screws.



## 3 Wiring

Connect the cable of the access controller to power cable and other ports according to the illustration.

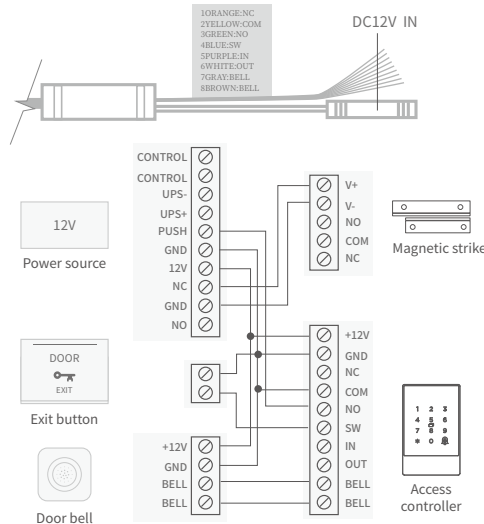

## 4 Install the hook

Fix the hook to the mounting plate with 2 screws.

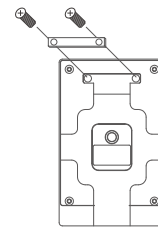

## 5 Install the access controller

Fit the access controller into the hook and fix it on the mounting plate with a screw in the bottom.

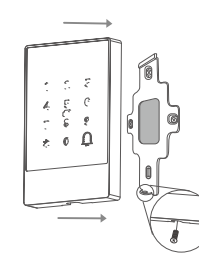

## Pair the access controller with app

- 1 Tap the panel to light it up and activate the lock.
- 2 On voice prompt "Please add Bluetooth Administrator", activate the APP.

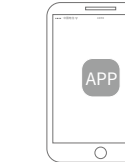
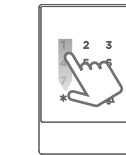

- 3 Tap the "☰" icon on the upper left corner, tap "+Add Lock", select "Door Lock".
- 4 Tap the device shown on the screen. Wait a few seconds till the lock gives a voice prompt/long beep, which means it is added successfully.

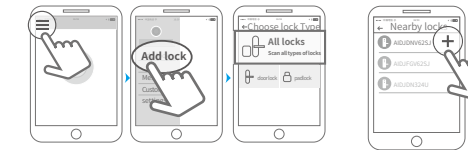

⚠ Notice: If fails, please shut off the APP and Bluetooth, turn them on and try the above process again.

## Limited Warranty

1. For any defect in material and workmanship, the original purchaser of the product
  - 1) Can return or ask for a replacement within 7 invoice days.
  - 2) Can ask for a replacement within 15 invoice days.
  - 3) Can ask for free repair in 365 invoice days.
2. This warranty does not cover defects caused by modification, alteration, misuse or physical abuse of the product.